



Testing Center

Main Building Room 221
(575)-234-9322

Accuplacer	8:00am-5:00pm	AGGIE ID NUMBER & Photo ID, Last exam administered 1 hour prior to closing
GED	8:00am-5:00pm	Prior registration, Government issued Photo ID
HESI A2	8:00am-12:00pm	Prior registration through the Nursing Department, Payment through Business Office and Photo ID
Certified Nursing Exam (CNA) <small>(Dates subject to change)</small>	7:30am-10:00am	Prior Online Registration, Photo ID and payment required

COMPASS exams are available after 5:00pm by appointment. Contact the Testing Center at (575) 234-9322 for more information.

We encourage you to leave all personal belongings, including purses and cell phones at home or secured in your vehicle. COMPASS scores are valid for up to one year.

AUGUST 2016							SEPTEMBER 2016							OCTOBER 2016							NOVEMBER 2016							DECEMBER 2016							JANUARY 2017							
M	T	W	T	F	S	S	M	T	W	T	F	S	S	M	T	W	T	F	S	S	M	T	W	T	F	S	S	M	T	W	T	F	S	S	M	T	W	T	F	S	S	
1	2	3	4	5	6	7				1	2	3	4						1	2		1	2	3	4	5	6				1	2	3	4							1	
8	9	10	11	12	13	14	5	6	7	8	9	10	11	3	4	5	6	7	8	9	7	8	9	10	11	12	13	5	6	7	8	9	10	11	2	3	4	5	6	7	8	
15	16	17	18	19	20	21	12	13	14	15	16	17	18	10	11	12	13	14	15	16	14	15	16	17	18	19	20	12	13	14	15	16	17	18	9	10	11	12	13	14	15	
22	23	24	25	26	27	28	19	20	21	22	23	24	25	17	18	19	20	21	22	23	21	22	23	24	25	26	27	19	20	21	22	23	24	25	16	17	18	19	20	21	22	
29	30	31					26	27	28	29	30			24	25	26	27	28	29	30	28	29	30					26	27	28	29	30	31		23	24	25	26	27	28	29	
														31																					30	31						
FEBRUARY 2017							MARCH 2017							APRIL 2017							MAY 2017							JUNE 2017							JULY 2017							
M	T	W	T	F	S	S	M	T	W	T	F	S	S	M	T	W	T	F	S	S	M	T	W	T	F	S	S	M	T	W	T	F	S	S	M	T	W	T	F	S	S	
		1	2	3	4	5			1	2	3	4	5						1	2	1	2	3	4	5	6	7				1	2	3	4							1	2
6	7	8	9	10	11	12	6	7	8	9	10	11	12	3	4	5	6	7	8	9	8	9	10	11	12	13	14	5	6	7	8	9	10	11	3	4	5	6	7	8	9	
13	14	15	16	17	18	19	13	14	15	16	17	18	19	10	11	12	13	14	15	16	15	16	17	18	19	20	21	12	13	14	15	16	17	18	10	11	12	13	14	15	16	
20	21	22	23	24	25	26	20	21	22	23	24	25	26	17	18	19	20	21	22	23	22	23	24	25	26	27	28	19	20	21	22	23	24	25	17	18	19	20	21	22	23	
27	28						27	28	29	30	31			24	25	26	27	28	29	30	29	30	31					26	27	28	29	30			24	25	26	27	28	29	30	
																																			31							



Testing Center Rules

- Valid Photo Identification is required.
- Children or other visitors are not allowed in the testing area. Children are not to be left alone in the building while taking an exam.
- Cell phones, keys, hats, sunglasses, book bags, purses, textbooks, notebooks, dictionaries, calculators or electronic devices are not allowed in the testing center.
- Food and drinks are not permitted in the testing area.
- Scratch papers with notes must be turned in after the exam.
- Leaving the Testing Center during testing will terminate the exam.
- Anyone caught giving or receiving help during the test, using notes, books or electronic devices will not be allowed to continue the test.
- NMSU Carlsbad may cancel any test score if there is reason to question the validity of the test scores.
- Disruptive behavior will result in removal from the Testing Center.

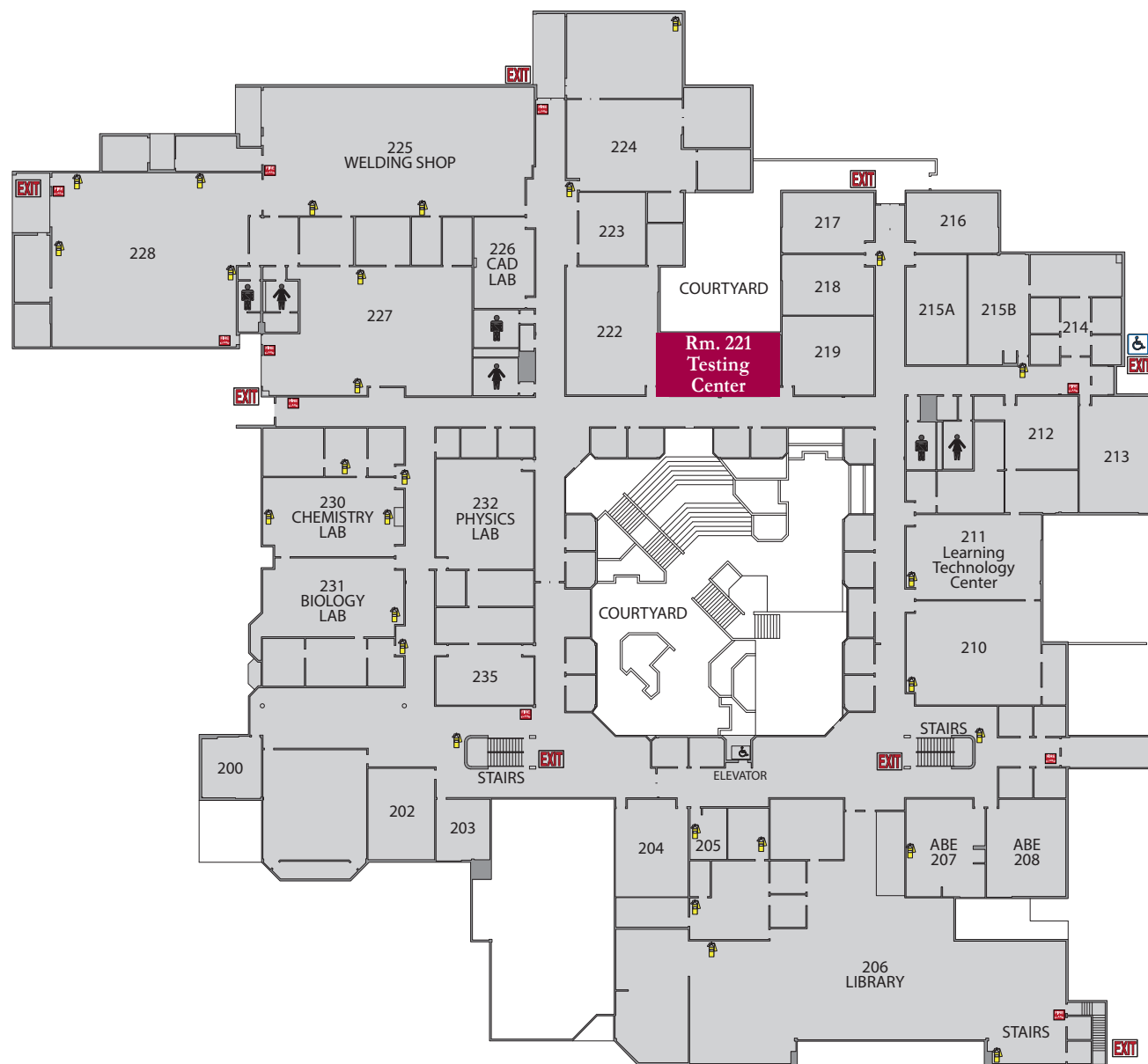

Main Building Second Floor